

5/14/20

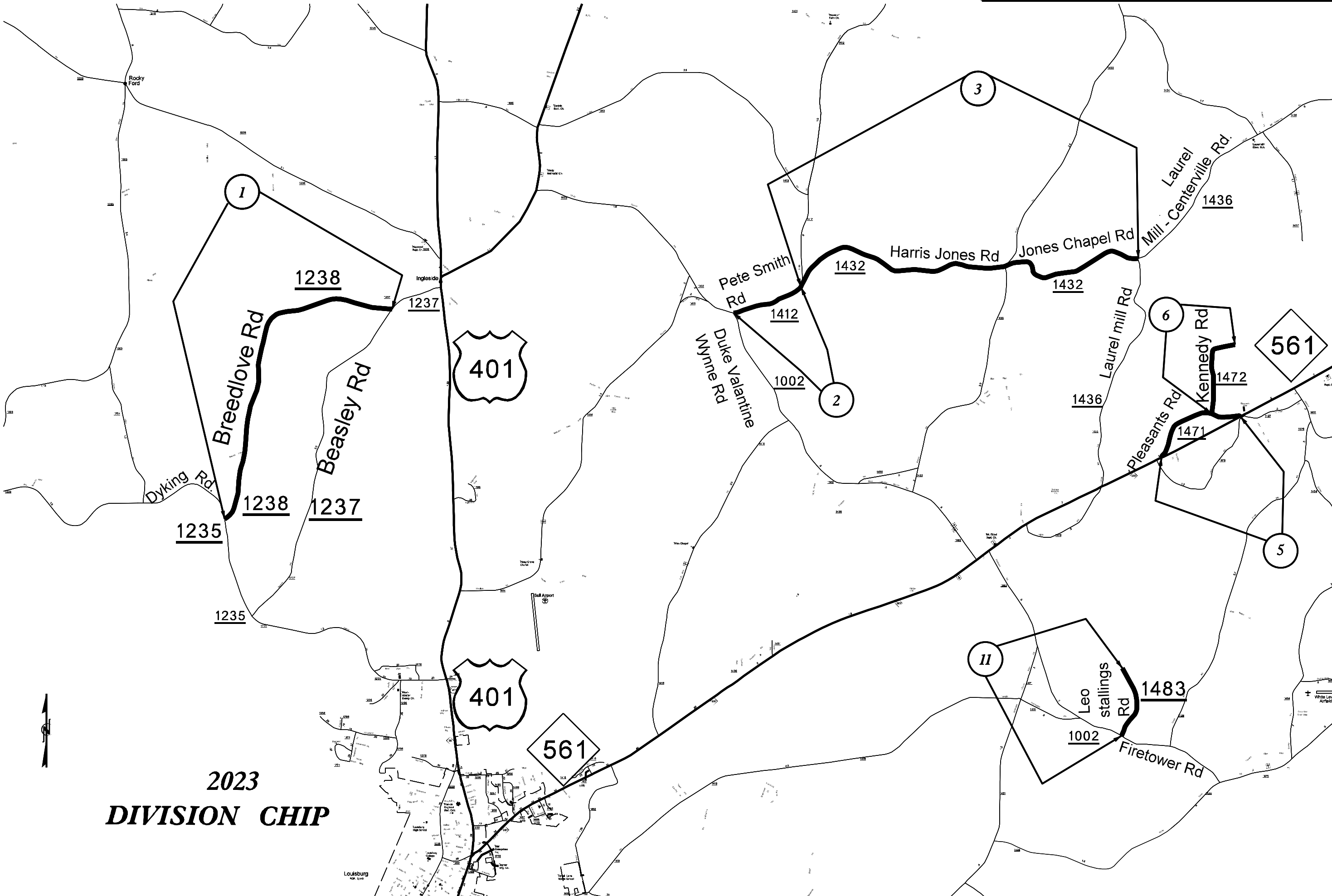

**2023
DIVISION CHIP**

SYSTEMS TIME 05/14/2023 10:00 AM

5/14/99

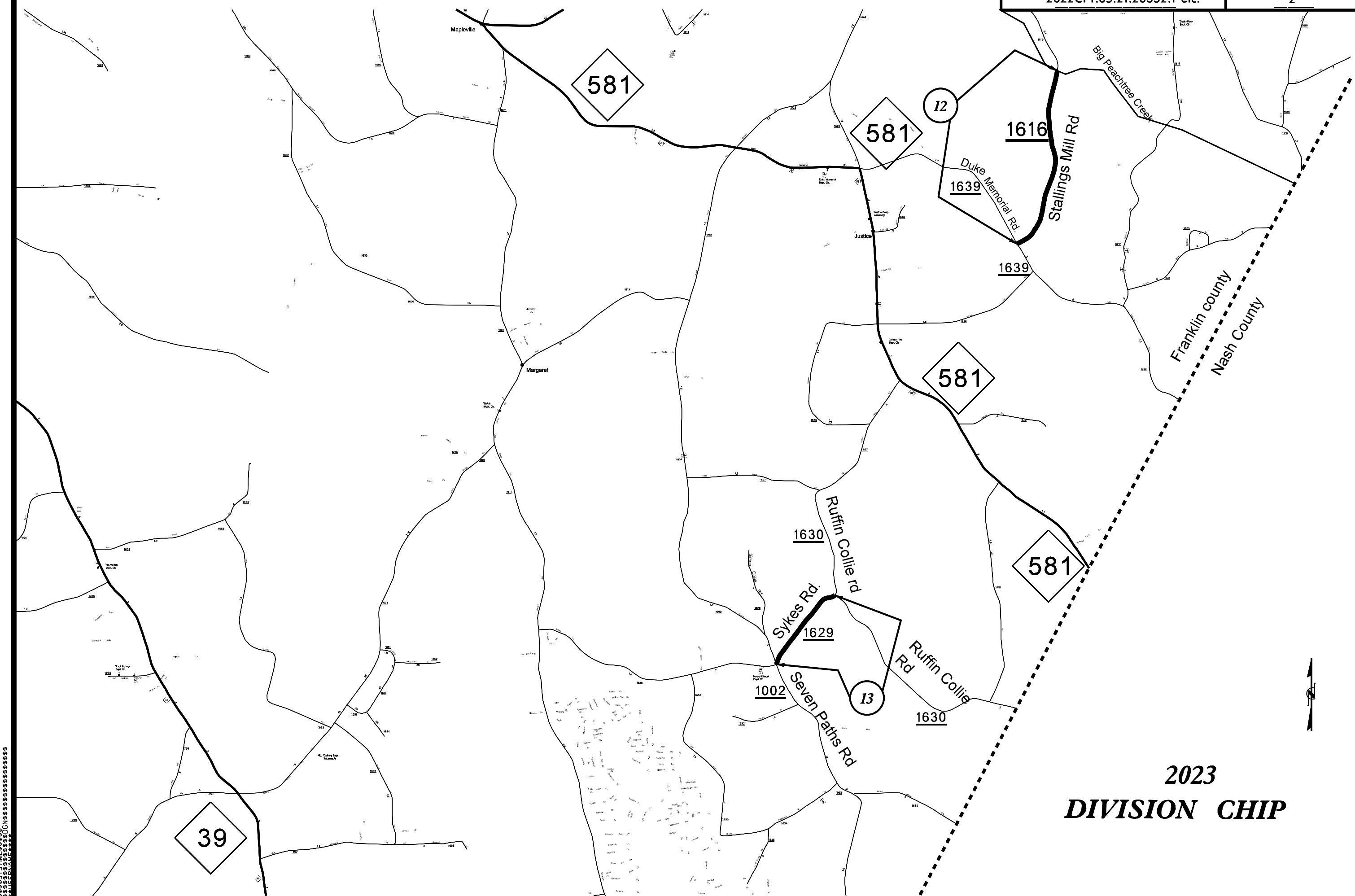

**2023
DIVISION CHIP**

SYSTEMS TIME SYSTEMS
 2023 DIVISION CHIP
 5/14/99

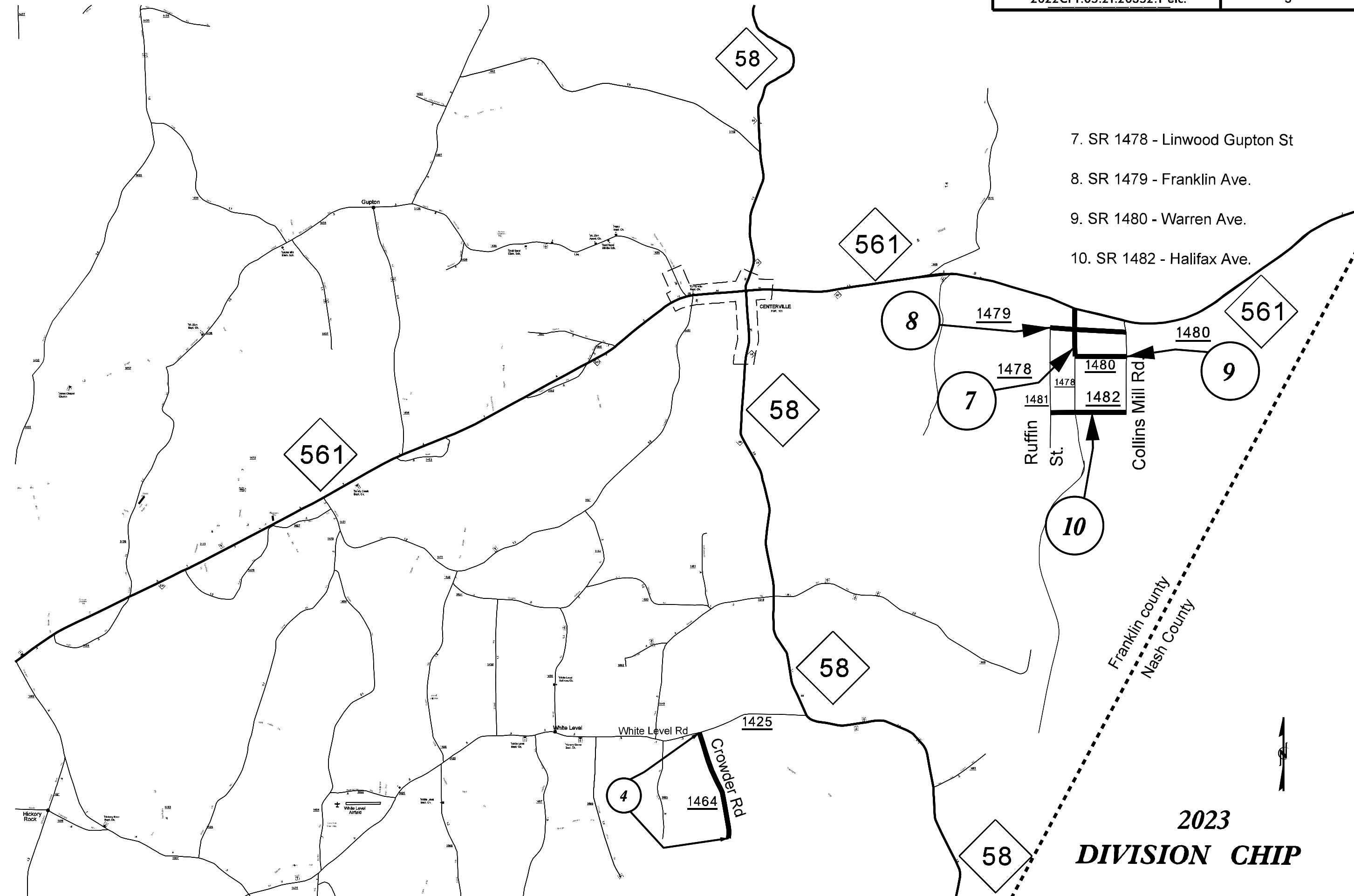

- 7. SR 1478 - Linwood Gupton St
- 8. SR 1479 - Franklin Ave.
- 9. SR 1480 - Warren Ave.
- 10. SR 1482 - Halifax Ave.

5/14/23

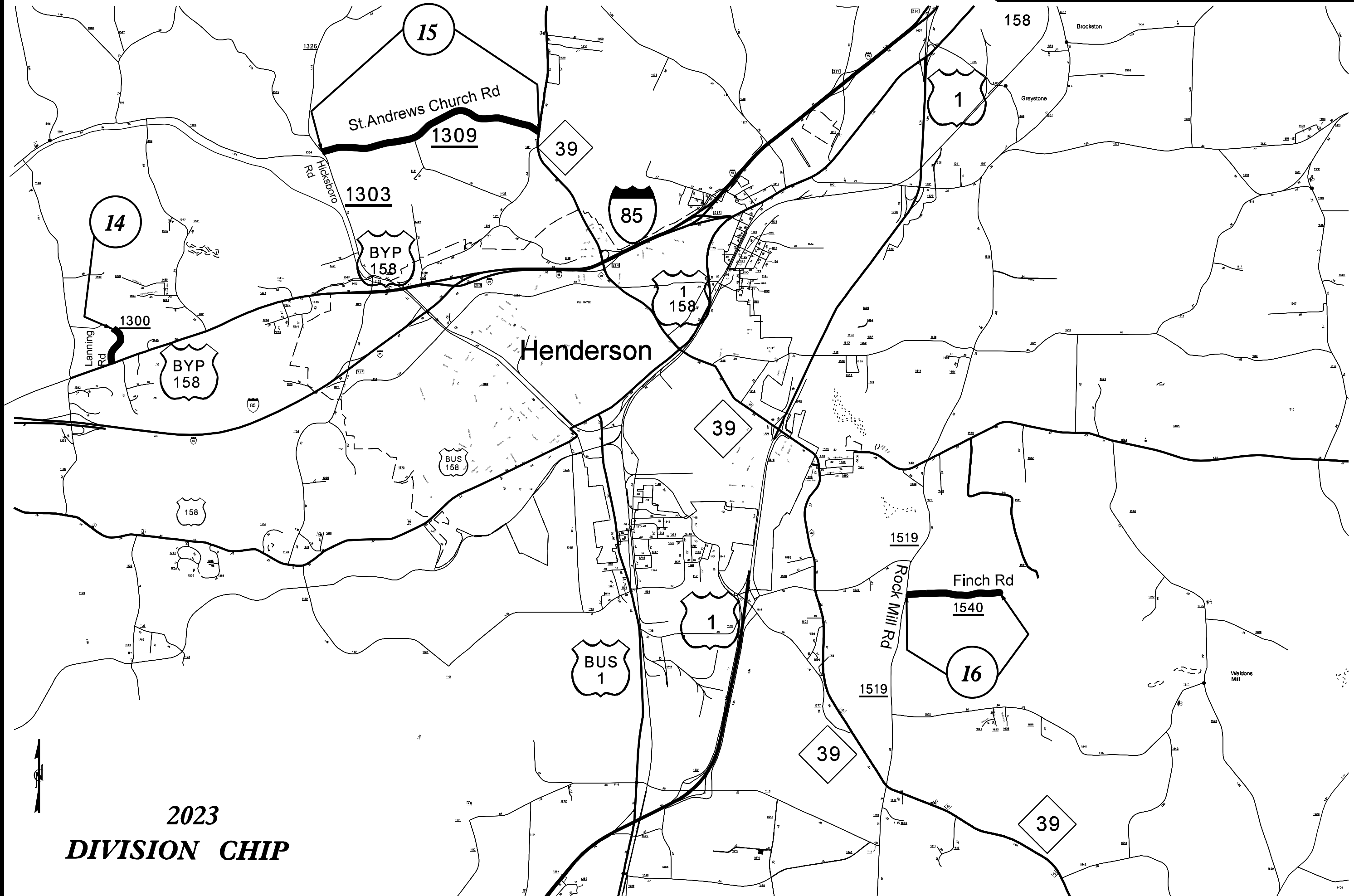

2023
DIVISION CHIP

SYSTEMS
 DIVISION



5/14/23

5/14/23
SYSTEMS DIVISION

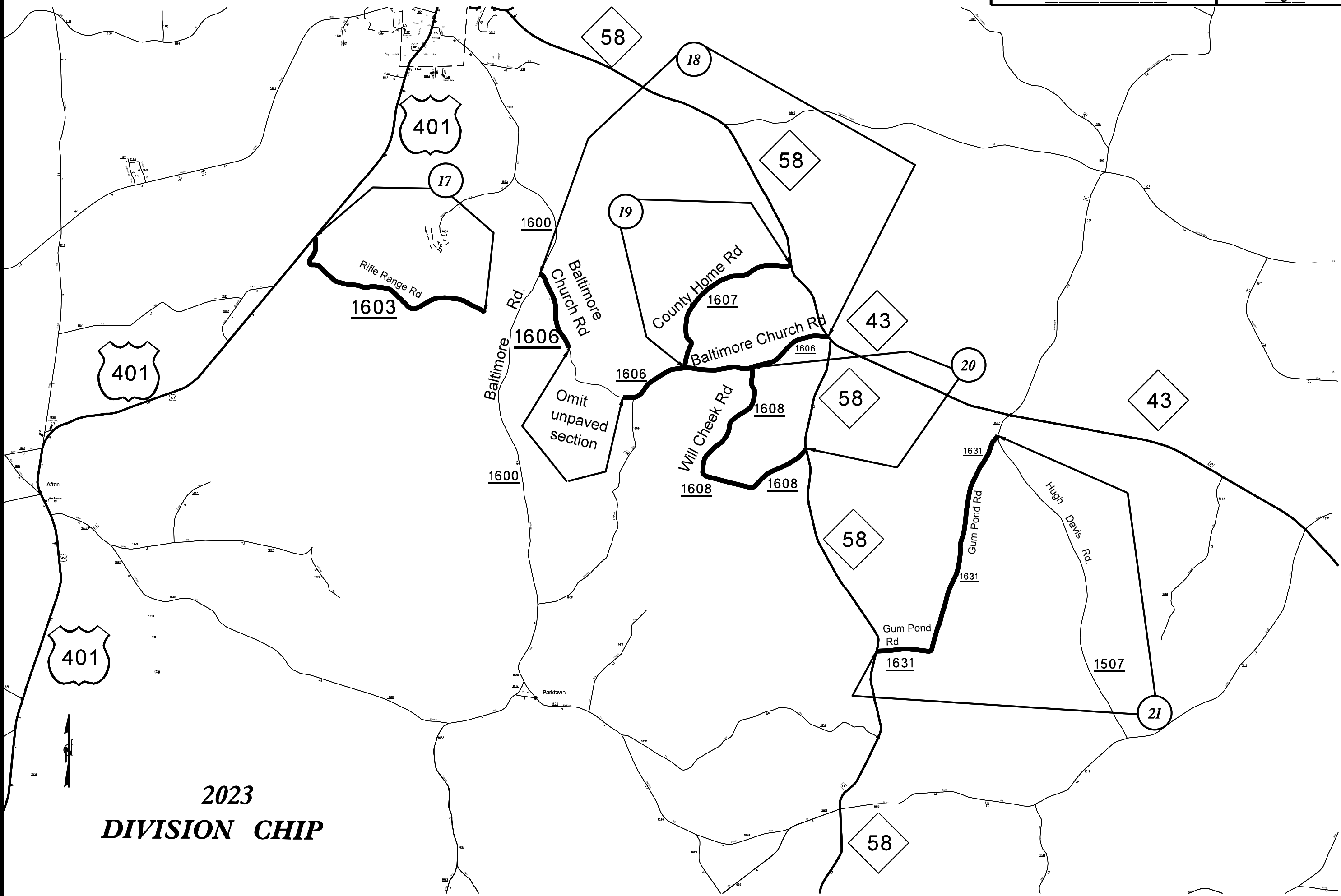

**2023
DIVISION CHIP**

PAVEMENT SCHEDULE

PROJECT REFERENCE NO.
2022CPT.05.21.20352.1 etc.

SHEET NO.
6

F1	PROP. ASPHALT SURFACE TREATMENT, DOUBLE SEAL
F2	PROP. FOG SEAL TO BE APPLIED WITHIN 5 DAYS OF DOUBLE SEAL ROADWAY SURFACE TO BE SWEEPED PRIOR TO FOG SEAL APPLICATION
U	EXISTING PAVEMENT

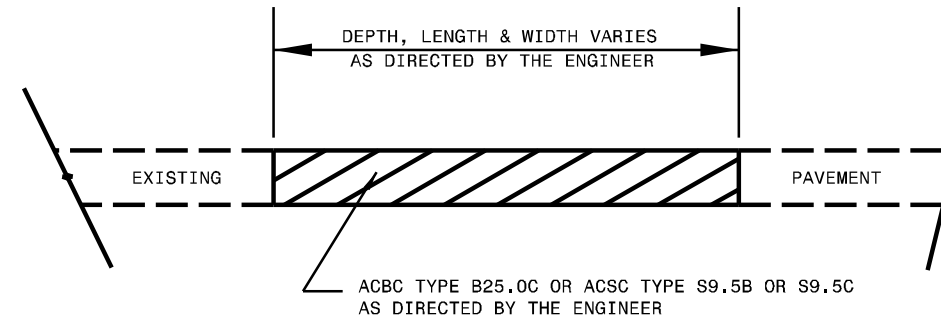

PATCHING EXISTING PAVEMENT
MILLING (IF REQUIRED BY TYPICAL) TO BE PERFORMED PRIOR TO PATCHING

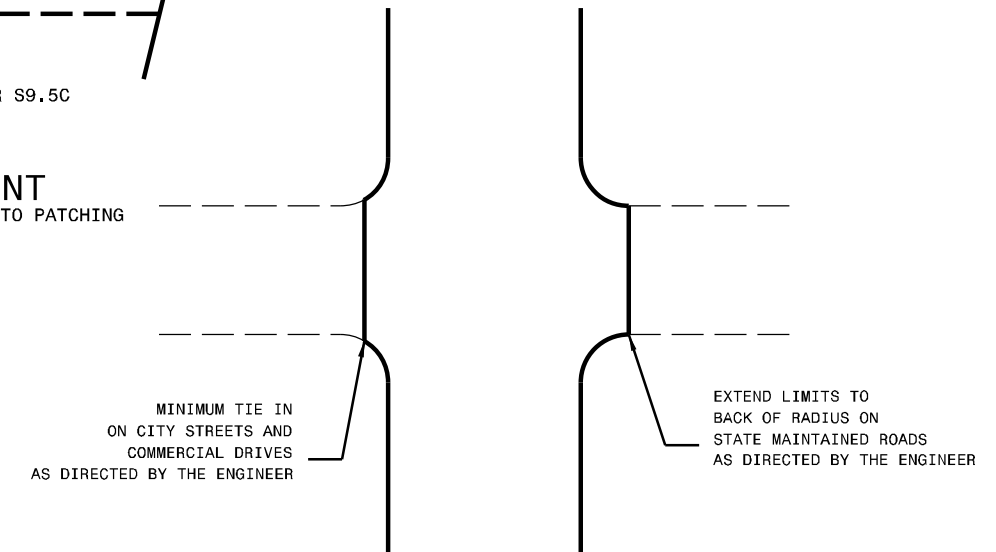

DETAIL OF PROJECT LIMITS AT Y LINES

SEAL TYPES AND MATERIAL APPLICATION RATES					
MAP #	TYPE OF SEAL	LAYER	AGGREGATE TYPE	AGGREGATE TARGET RATES (LBS/SY)	EMULSION TARGET RATES (GAL/SY)
ALL MAPS	DOUBLE	BOTTOM	78M	18	0.30
		TOP	9M	9	0.25
			EMULSION TYPE		
map #5-15	FOG SEAL	WITHIN 5 DAYS OF DOUBLE SEAL	CSS-1H		0.12

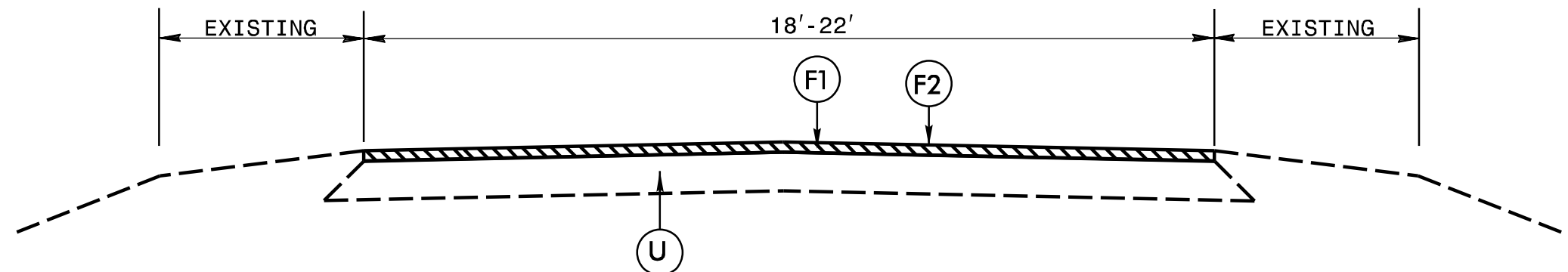

TYPICAL SECTION 1

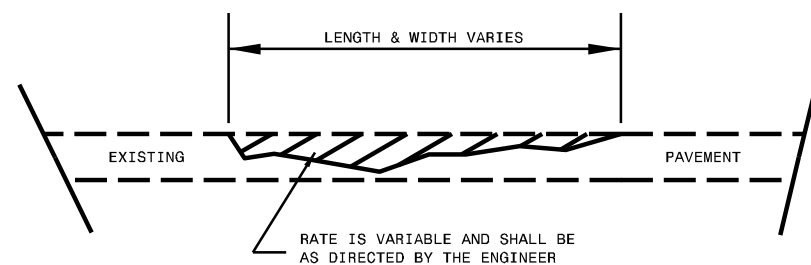

ASPHALT CONCRETE SURFACE COURSE (LEVELING COURSE)

PROJECT NO.	SHEET NO.	TOTAL NO.
2022CPT.05.21.20352.1, etc	7	

SUMMARY OF QUANTITIES

PROJECT NO	COUNTY	MAP NO	ROUTE	DESCRIPTION	TYP NO	LANES	FINAL SURFACE TESTING REQUIRED	WARM MIX ASPHALT REQUIRED	LENGTH		1520000000-E	1575000000-E	1704000000-E	1803500000-E	1820000000-E	1838000000-E
									MI	FT	LEVELING COURSE, TYPE S9.5B	ASPHALT BINDER FOR PLANT MIX	PATCHING EXISTING PAVEMENT	ASPHALT SURFACE TREATMENT, DOUBLE SEAL	ASPHALT SURFACE TREATMENT, FOG SEAL	EMULSION FOR ASPHALT SURFACE TREATMENT
											TON	TON	TONS	SY	SY	GAL
2022CPT.05.21.20352.1	Franklin	1	SR 1238 - BREEDLOVE RD	SR 1237 - BEASLEY RD TO SR 1235 - DYKING RD	1	2	NO	NO	2.8	20			70	32,853	32,853	18,069
		2	SR 1412 - PETE SMITH RD	SR 1432 - HARRIS JONES RD TO 285' EAST OF SR 1002 - DUKE VALENTINE WYNNE RD	1	2	NO	NO	0.59	18			10	6,230	6,230	3,427
		3	SR 1432 - JONES CHAPEL RD/HARRIS JONES RD	SR 1412 - PETE SMITH RD TO SR 1436- LAUREL MILL RD	1	2	NO	NO	3.16	18			15	33,370	33,370	18,353
		4	SR 1464 - CROWDER RD	SR 1425 - WHITE LEVEL RD TO END MAINTENANCE	1	2	NO	NO	0.91	20			10	10,677	10,677	5,873
		5	SR 1471 - PLEASANTS RD	NC 561 TO NC 561	1	2	NO	NO	0.87	18			60	9,187	9,187	5,053
		6	SR 1472 - KENNEDY RD	SR 1471 - PLEASANTS RD TO CUL-DE-SAC	1	2	NO	NO	0.73	20			360	8,851	8,851	4,868
		7	SR 1478 - LINWOOD GUPTON ST	NC 561 TO END PAVMT	1	2	NO	NO	0.13	18			5	1,373	1,373	755
		8	SR 1479 - FRANKLIN AVE	SR 1449 - COLLINS MILL RD TO SR 1481- RUFFIN ST	1	2	NO	NO	0.19	18			10	2,006	2,006	1,104
		9	SR 1480- WARREN AVE	SR 1449 - COLLINS MILL RD TO 1478- LINWOOD GUPTON ST	1	2	NO	NO	0.13	18			5	1,373	1,373	755
		10	SR 1482 - HALIFAX AVE	SR 1449 - COLLINS MILL RD TO SR 1481 - RUFFIN ST	1	2	NO	NO	0.19	18			25	2,006	2,006	1,104
		11	SR 1483 - LEO STALLINGS RD	SR 1002 - FIRETOWER RD TO DEAD END	1	2	NO	NO	0.63	20			5	7,392	7,392	4,066
		12	SR 1616 - STALLINGS MILL RD	BIG PEACHTREE CREEK TO SR 1639 - DUKE MEMORIAL RD	1	2	NO	NO	1.56	18			10	16,474	16,474	9,060
		13	SR 1629 - SYKES RD	SR 1002 - SEVEN PATHS RD TO SR 1630 - RUFFIN COLLIE RD	1	2	NO	NO	0.78	19			10	8,694	8,694	4,782
TOTAL FOR PROJ NO. 2022CPT.05.21.20352.1									12.67			595	140,486	140,486	77,269	
2022CPT.05.21.20912.1	Vance	14	SR 1300 - LANNING RD	US 158 TO END PVMT	1	2	NO	NO	0.19	22			35	2,465	2,465	1,356
		15	SR 1309 - ST. ANDREWS CHURCH RD	SR 1303 - HICKSBORO RD TO NC 39	1	2	NO	NO	1.94	20	85	6	31	22,763	22,763	12,513
		16	SR 1540 - FINCH RD	SR 1519 - ROCK MILL RD TO CUL- DE-SAC	1	2	NO	NO	0.8	20			15	9,963	9,963	5,480
TOTAL FOR PROJ NO. 2022CPT.05.21.20912.1									2.93		85	6	81	35,191	35,191	19,349
2022CPT.05.21.20932.1	Warren	17	SR 1603 - RIFLE RANGE RD	US 401 TO CUL-DE-SAC	1	2	NO	NO	1.82	21			15	21,583	21,583	11,871
		18	SR 1606 - BALTIMORE CHURCH RD	BALTIMORE RD (OMIT 0.76 MILES UNPAVED SECTION) TO NC 58	1	2	NO	NO	2.549	20			20	29,908	29,908	16,456
		19	SR 1607 - COUNTY HOME RD	SR 1606 - BALTIMORE CHURCH RD TO NC 58	1	2	NO	NO	1.48	20			10	17,365	17,365	9,551
		20	SR 1608 - WILL CHEEK RD	SR 1606 - BALTIMORE CHURCH RD TO NC 58	1	2	NO	NO	2.08	20			20	24,405	24,405	13,404
		21	SR 1631 - GUM POND RD	SR 1507 - HUGH DAVIS RD TO NC 58	1	2	NO	NO	2.38	20			100	27,925	27,925	15,359
TOTAL FOR PROJ NO. 2022CPT.05.21.20932.1									10.309			165	121,186	121,186	66,641	
GRAND TOTAL									25.909		85	6	841	296,863	296,863	163,259

PROJECT NO.	SHEET NO.	TOTAL NO.
2022CPT.05.21.20352.1, etc.	8	

THERMOPLASTIC AND PAINT QUANTITIES

PROJECT NO	COUNTY	MAP NO	ROUTE	DESCRIPTION	TYP NO	LANES	LENGTH		WIDTH	4413000000-E	4457000000-N	4720000000-E	4725000000-E	4890000000-E	4890000000-E
							WORK ZONE ADVANCE/GENERAL WARNING SIGNING	TEMPORARY TRAFFIC CONTROL		THERMO MSG SCHOOL 90 M	THERMO LT ARROW 90 M	HOT SPRAY THERMOPLASTIC PAVEMENT MARKING LINES, 4", 50 MIL	GENERIC PAVEMENT MARKING ITEM 24" X 90 M WHITE THERMO		
							MI	FT		SF	LS	EA	EA	LF	LF
2022CPT.05.21.20352.1	Franklin	1	SR 1238 - BREEDLOVE RD	SR 1237 - BEASLEY RD TO SR 1235 - DYKING RD	1	2	2.8	20		314	0.11			59,696	
		2	SR 1412 - PETE SMITH RD	SR 1432 - HARRIS JONES RD TO 285' EAST OF SR 1002 - DUKE VALENTINE WYNNE RD	1	2	0.59	18		126	0.02			12,578	
		3	SR 1432 - JONES CHAPEL RD/HARRIS JONES RD	SR 1412 - PETE SMITH RD TO SR 1436- LAUREL MILL RD	1	2	3.16	18		354	0.11			67,372	
		4	SR 1464 - CROWDER RD	SR 1425 - WHITE LEVEL RD TO END MAINTENANCE	1	2	0.91	20		102	0.03			19,402	
		5	SR 1471 - PLEASANTS RD	NC 561 TO NC 561	1	2	0.87	18		97	0.03				
		6	SR 1472 - KENNEDY RD	SR 1471 - PLEASANTS RD TO CUL-DE-SAC	1	2	0.73	20		82	0.06				
		7	SR 1478 - LINWOOD GUPTON ST	NC 561 TO END PAVMT	1	2	0.13	18		15	0.01				
		8	SR 1479 - FRANKLIN AVE	SR 1449 - COLLINS MILL RD TO SR 1481- RUFFIN ST	1	2	0.19	18		21	0.01				
		9	SR 1480- WARREN AVE	SR 1449 - COLLINS MILL RD TO 1478- LINWOOD GUPTON ST	1	2	0.13	18		15	0.01				
		10	SR 1482 - HALIFAX AVE	SR 1449 - COLLINS MILL RD TO SR 1481 - RUFFIN ST	1	2	0.19	18		21	0.01				
		11	SR 1483 - LEO STALLINGS RD	SR 1002 - FIRETOWER RD TO DEAD END	1	2	0.63	20		71	0.02				
		12	SR 1616 - STALLINGS MILL RD	BIG PEACHTREE CREEK TO SR 1639 - DUKE MEMORIAL RD	1	2	1.56	18		175	0.05				33,260
		13	SR 1629 - SYKES RD	SR 1002 - SEVEN PATHS RD TO SR 1630 - RUFFIN COLLIE RD	1	2	0.78	19		87	0.03				16,629
TOTAL FOR PROJ NO. 2022CPT.05.21.20352.1							12.67		1,480	0.50			208,937		
2022CPT.05.21.20912.1	Vance	14	SR 1300 - LANNING RD	US 158 TO END PAVMT	1	2	0.19	22		21	0.01	6	2	4,050	50
		15	SR 1309 - ST. ANDREWS CHURCH RD	SR 1303 - HICKSBORO RD TO NC 39	1	2	1.94	20		217	0.08			41,360	
		16	SR 1540 - FINCH RD	SR 1519 - ROCK MILL RD TO CUL- DE-SAC	1	2	0.8	20		111	0.04			21,106	
TOTAL FOR PROJ NO. 2022CPT.05.21.20912.1							2.93		349	0.13	6	2	66,516	50	
2022CPT.05.21.20932.1	Warren	17	SR 1603 - RIFLE RANGE RD	US 401 TO CUL-DE-SAC	1	2	1.82	21		204	0.06			38,803	
		18	SR 1606 - BALTIMORE CHURCH RD	BALTIMORE RD (OMIT 0.76 MILES UNPAVED SECTION) TO NC 58	1	2	2.549	20		305	0.10			58,203	
		19	SR 1607 - COUNTY HOME RD	SR 1606 - BALTIMORE CHURCH RD TO NC 58	1	2	1.48	20		166	0.05			31,553	
		20	SR 1608 - WILL CHEEK RD	SR 1606 - BALTIMORE CHURCH RD TO NC 58	1	2	2.08	20		233	0.07			44,345	
		21	SR 1631 - GUM POND RD	SR 1507 - HUGH DAVIS RD TO NC 58	1	2	2.38	20		267	0.09			50,741	
TOTAL FOR PROJ NO. 2022CPT.05.21.20932.1							10.309		1,175	0.37			223,645		
GRAND TOTAL							25.909		3,004	1.00	6	2	499,098	50	

SIGNING FOR ASPHALT SURFACE TREATMENT

LEGEND

- PORTABLE SIGN
- STATIONARY SIGN
- DIRECTION OF TRAFFIC FLOW

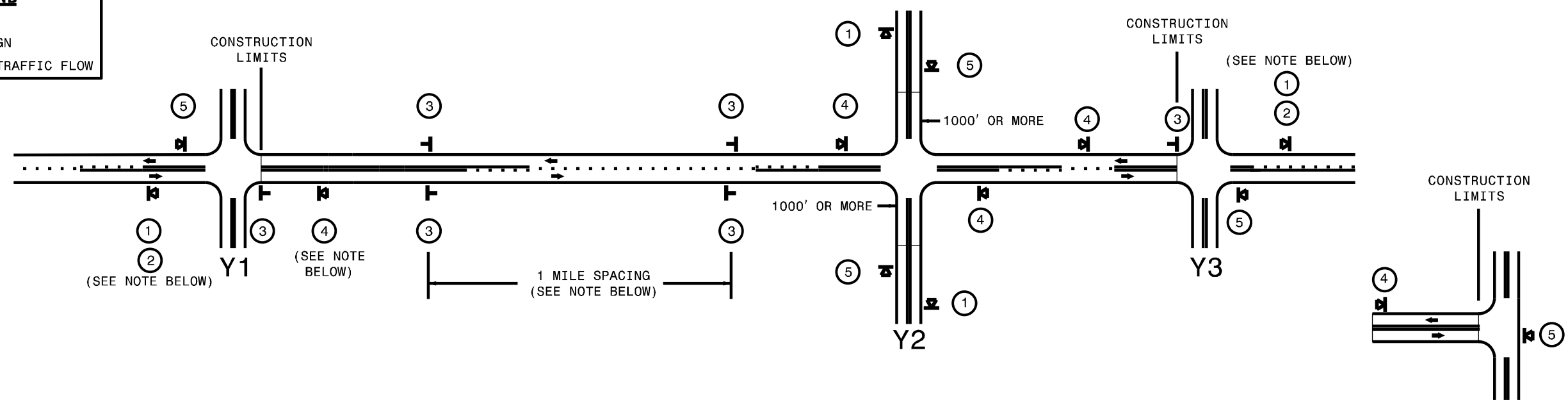

MAINLINE (-L-) SIGNING

-Y- LINE SIGNING

SIGNING NOTES AND PLACEMENT PER DIRECTION		<ul style="list-style-type: none"> - PLACE 1000' PRIOR TO BEGINNING OF CONSTRUCTION LIMITS. ONLY USED ON -Y- LINES IF RESURFACING LIMITS EXTEND 1000' ALONG -Y- LINE. 	<p>STATIONARY SIGNING NOT REQUIRED FOR THE FOLLOWING -Y- LINE CONDITIONS:</p> <ol style="list-style-type: none"> 1) LESS THAN 1000' OF RESURFACING ALONG -Y- LINE 2) SUBDIVISION ROADS 3) DEAD END ROADS <p>WHEN PAVING/CONSTRUCTION ACTIVITIES PROCEED ACROSS AN UNSIGNED -Y- LINE, PORTABLE ADVANCE WARNING SIGNS SHALL BE USED ALONG THE -Y- LINE AS SHOWN BELOW. REMOVE UPON COMPLETION OF WORK.</p> <div style="display: flex; justify-content: space-around;"> <div style="text-align: center;"> <p>PLACED 500' IN ADVANCE OF FLAGGER.</p> </div> <div style="text-align: center;"> <p>PLACED 250' IN ADVANCE OF FLAGGER.</p> </div> </div>
		<ul style="list-style-type: none"> - SIGN #2 ONLY USED WHEN RESURFACING LIMITS ARE 2 OR MORE MILES IN LENGTH. ROUND UP TO THE NEAREST WHOLE NUMBER. DO NOT USE FRACTIONAL OR DECIMAL NUMBERS. 	
		<ul style="list-style-type: none"> - ALTERNATE THE FOLLOWING TWO SIGNS: - STARTING WITH "LOOSE GRAVEL" (W8-7) FOLLOWED BY "UNMARKED PAVEMENT". - PLACE INITIALLY AT THE CONSTRUCTION LIMITS AND SPACED 1 MILE APART THEREAFTER. 	
		<ul style="list-style-type: none"> - AT TEE INTERSECTIONS INSTALL INITIALLY 0.5 MILE FROM INTERSECTION AND SPACE 1 MILE APART THEREAFTER. 	
		<ul style="list-style-type: none"> - THESE ARE FOR -Y- LINES THAT ARE "THROUGH" ROADWAYS. DEAD END AND SUBDIVISION ROADS ARE NOT "THROUGH" ROADWAYS. - INSTALL 500' +/- FROM EACH -Y- LINE APPROACH AS SHOWN ABOVE. - FOR MULTIPLE -Y- LINES THAT ARE SEPARATED BY 0.25 MILES OR LESS, TREAT AS A SINGLE UNIT AND INSTALL WITHIN 500' OF EACH APPROACH. - A MAXIMUM OF 2 SIGN SETS PER MILE. DO NOT INSTALL WHEN -Y- LINES ARE WITHIN 0.5 MILES FROM "END ROAD WORK" SIGN. 	
	<ul style="list-style-type: none"> - PLACE 500' FOLLOWING THE END OF CONSTRUCTION LIMITS OR AS SHOWN WHEN WORK ENDS AT A 3-WAY TEE INTERSECTION. 		

THE ABOVE SIGNS ARE ALL THAT ARE REQUIRED FOR A CONTRACTOR TO BEGIN A RESURFACING CONTRACT. ANY ADDITIONAL SIGNS REQUESTED BY NCDOT DIVISIONS SHALL BE INSTALLED WITHIN 7 BUSINESS DAYS OF THE START OF CONTRACT WORK.

MAPS LESS THAN 2 MILES

FOR AST RESURFACING MAPS WITH CONSTRUCTION LIMITS LESS THAN 2 MILES IN LENGTH, USE A STATIONARY "LOOSE GRAVEL" SIGN AT THE BEGINNING CONSTRUCTION LIMIT FOLLOWED BY AN "UNMARKED PAVEMENT" SIGN MIDWAY THROUGH AND AN "END ROAD WORK" SIGN AT THE END CONSTRUCTION LIMIT.



ADVANCE WARNING SIGNS FOR 2-LANE ROADWAY ASPHALT SURFACE TREATMENT

\$\$\$SYTIME\$\$\$\$\$
 \$\$\$DCON\$\$\$\$\$
 \$\$\$USERNAME\$\$\$\$\$